

MSHSAA SHOW-ME SCHOLAR BOWL CHALLENGE

STATE SCHOLAR BOWL TOURNAMENT - KEY LOCATIONS

University of Missouri Campus: Memorial Student Union

Class 1 and 2: Friday, May 3, 2019; Class 3 and 4, Saturday, May 4, 2019

Main Floor



Stotler 2:

- MSHSAA Headquarters
- Team Check-In

Stotler 1 and Stotler 3:

- Competition Rooms

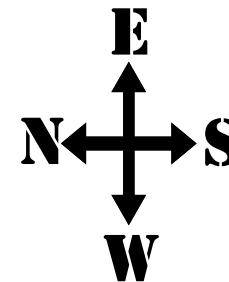

ENTER HERE through the Archway/Breezeway of the Union into the North Side

MSHSAA SHOW-ME SCHOLAR BOWL CHALLENGE
STATE SCHOLAR BOWL TOURNAMENT - KEY LOCATIONS
University of Missouri Campus: Memorial Student Union
Class 1 and 2: Friday, May 3, 2019; Class 3 and 4, Saturday, May 4, 2019

Second Floor

North Side

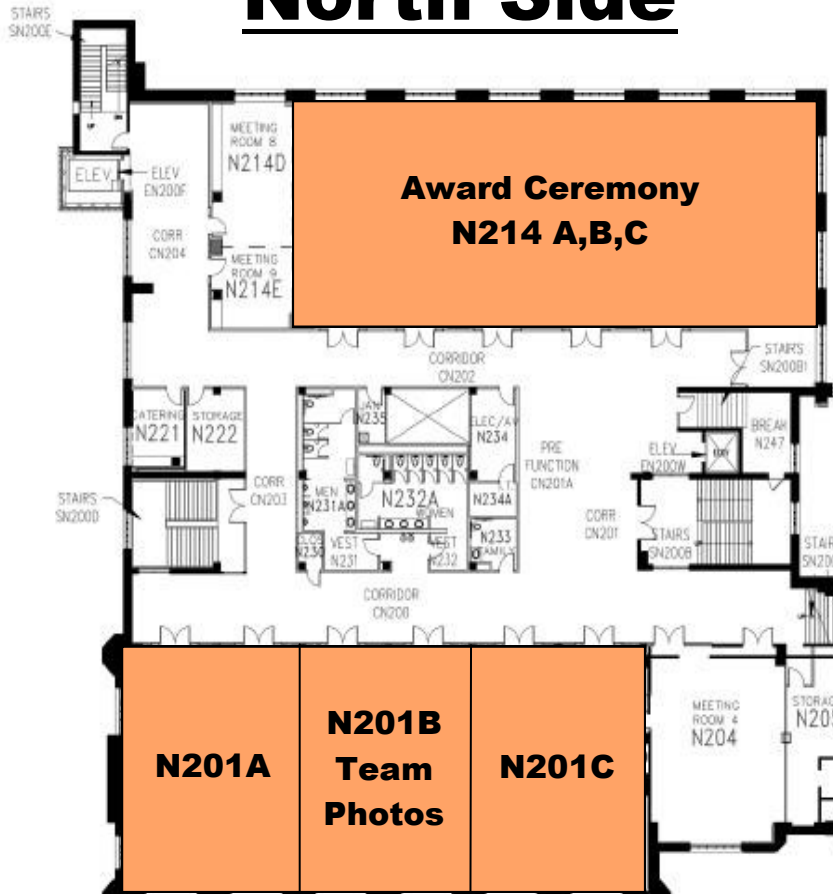

Competition Rooms:

- North: N201A and N201C
- South: S203, S204, S206 & S207

Team Photos: N201B

Award Ceremony: N214 A,B,C

South Side

