

Stewart Hall Basement

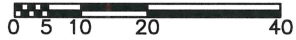
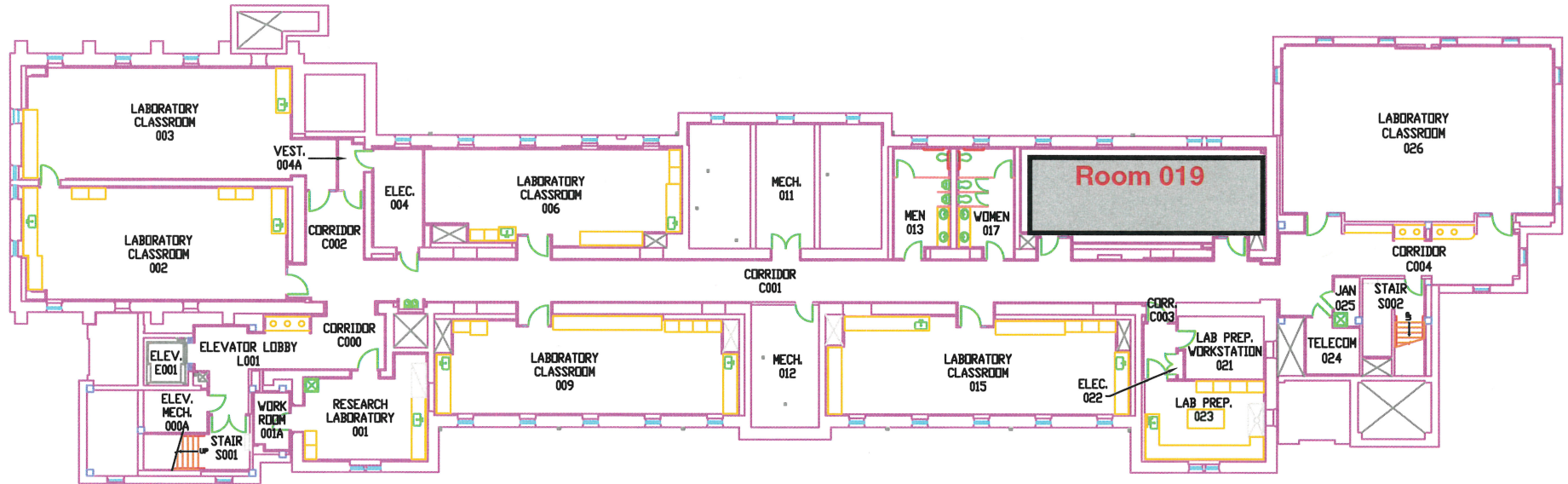

**CAMPUS FACILITIES
SPACE PLANNING & MANAGEMENT**
(573) 882-4506

STEWART HALL

REVISED: 10-10-2017 CSW

LEVEL: BASEMENT	TOUR DATE: TBD	SCALE: NTS	
BUILDING NO: 37064	SHEET: 1 OF 4	GROSS SQ FT: 15,959	

NORTH

Stewart Hall
First Floor

